

## Cutters and inserts for tube bevelers

### REGULAR CUTTERS

FOR USE WITHOUT HOLDERS  
BIT: HSS and HSS Cobalt

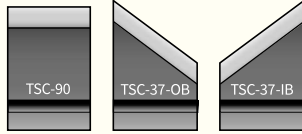

Cutters for MiniMill series

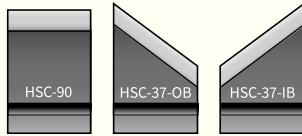

Cutters for HyperMill series

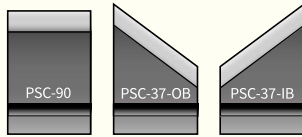

Cutters for PipeMill series

### INSERTS

Inserts options:  
HSS-Co 5% cobalt  
HSS-Co-AN 5% cobalt + ANOVA coating  
HSS-M2  
HSS-M2-TiN HSS+TiN coating



CI	A	B
mm	5	5

MAT: Carbide  
Screw: MHS-2



CI7	A	B
mm	7	7

MAT: Carbide  
Screw: MHS-2,7



CS	A	B
mm	9,5	9,5

MAT: HSS 6% Cobalt  
Screw: MHS-4



CSZ	A	B
mm	5,8	9,5

MAT: HSS 6% Cobalt  
Screw: MHS-2,5



CSS-CB	A	B
mm	6,3	9,5

MAT: HSS 6% Carbide  
Screw: MHS-2,5



CSS	A	B
mm	6,3	9,5

MAT: HSS 6% Cobalt  
Screw: MHS-2,5



PO8	R
mm	8

MAT: Carbide  
Screw: MHS-2,7

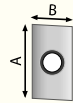

CDI	A	B
mm	18	9,5

MAT: HSS 6% Cobalt  
Screw: MHS-4

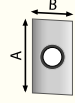

CDI-CB	A	B
mm	18	9,5

MAT: HSS 6% Carbide  
Screw: MHS-4

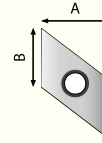

WRIL	A	B
mm	13,5	9,5

MAT: HSS 6% Cobalt  
Screw: MHS-4

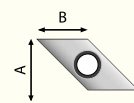

WRK	A	B
mm	10	9,5

MAT: HSS 6% Cobalt  
Screw: MHS-4

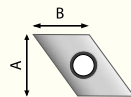

WRI	A	B
mm	13,5	9,5

MAT: HSS 6% Cobalt  
Screw: MHS-4



	A	B	R
CDJ-2.5*	18	9,5	2,5
CDJ-5	18	9,5	4,7
CDJ-8*	18	9,5	8,0

MAT: HSS 6% Cobalt  
Screw: MHS-4  
\* na zamówienie

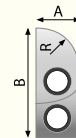

CSWR	A	B	R
mm	6,5	16,5	6

MAT: HSS 6% Cobalt  
Screw: MHS-2,5

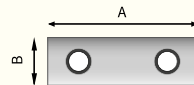

2CDI	A	B
mm	45	12,7

MAT: HSS 6% Cobalt  
Screw: MHS-5

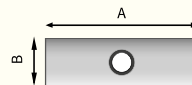

CDK	A	B
mm	25	9,5

MAT: HSS 6% Cobalt  
Screw: MHS-5

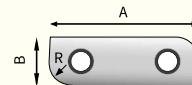

2CDJ-5	A	B	R
mm	45	12,7	4,7

MAT: HSS 6% Cobalt  
Screw: MHS-5



CSS-127	Min	Max
mm	9,5	15,0

MAT: HSS 6% Cobalt